

Mountain View County has received an approval from the Province of Alberta to test around the existing county gravel extraction operation located on Township 290 south west of the intersection of Range Road 53 for the purposes of future pit expansion. The results of this testing will be submitted to the Province of Alberta to determine if a future pit expansion is granted.

History of this location

Mountain View County started operating this gravel pit in 1965. This location was utilized as a gravel pit by Alberta Transportation and a local construction company from Cremona prior to the County.

Importance

Since 1979 the county has used nearly 1,000,000 tonnes of gravel from this location. In the last 5 years nearly 25% of gravel usage county wide has been from this gravel pit. Material from this pit has been used to re-gravel roads, repair roads, chip seal hard surface roads and pave roads within the county. This pit is used primarily for roads in the Water Valley area.

Exploration

The County is planning to expand the surface lease to allow the county to access gravel long into the future. Prior to any expansion the Province requires that testing be done to prove the quality and quantity of the gravel. The County has been working with the Province and the grazing lease holder to obtain permission to access the land for testing. In order to accommodate the testing some logging needs to occur to clear access for the equipment.

Tree Clearing

The logging is planned to occur in 2019 prior to road bans in March. The areas to be logged are within the existing lease that county has and the pathways for equipment access for the testing. No other logging is planned at this time. The County has contracted the logging to Spray Lakes Sawmills out of Cochrane. The logging techniques will be the most up to the date in the industry and the area will be left to the specifications of the grazing lease holder. The haul route for the logs will be to head north to Range Road 53, east on Highway 579 and then south on Highway 22 to Cochrane.

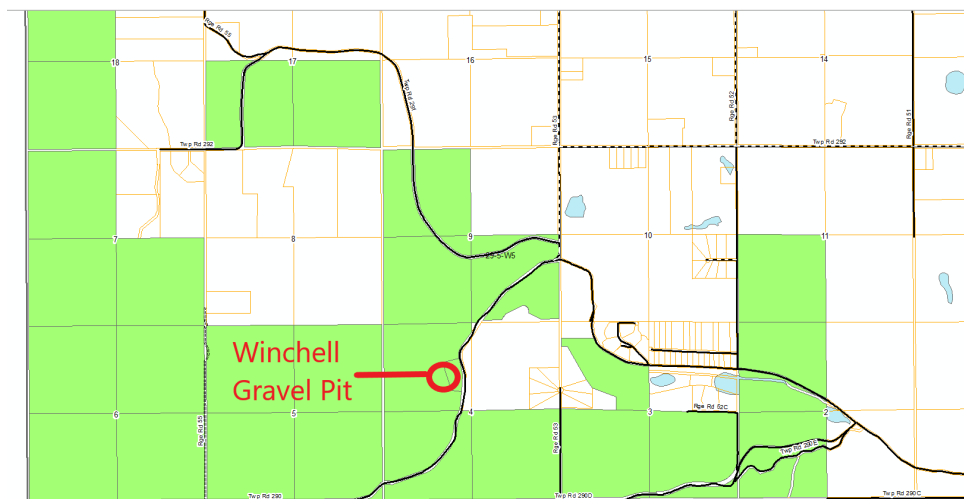

Mountain View County manages this pit under our current Operating Guidelines that all pits follow in the county. The amount of material used and the level of activity in this pit will be similar to what the residents have been used to for the past 50 years.