

<b>MGB FILE NO.</b>	<b>17/IMD-004</b>	<b>RECEIVED</b>	EXHIBIT NO. _____  FOR MGB USE ONLY
<b>IN THE MATTER OF</b>	<b>AN INTERMUNICIPAL DISPUTE</b>		
<b>INITIATING MUNICIPALITY</b>	<b>TOWN OF SUNDRE</b>		
<b>RESPONDENT MUNICIPALITY</b>	<b>MOUNTAIN VIEW COUNTY</b>		
<b>DOCUMENT</b>	<b>UNBOUND HARD COPY OF THE ADOPTED BYLAW LU43/17</b>		
<b>NAME (ORGANIZATION)</b>  <b>ADDRESS FOR SERVICE</b>  <b>EMAIL</b>  <b>TELEPHONE</b>  <b>(FOR PERSON FILING THIS DOCUMENT)</b>	<b>MOUNTAIN VIEW COUNTY</b>  <b>POSTAL BAG 100, DIDSBURY, AB T0M 0W0</b>  <b>mbloem@mvcountry.com</b>  <b>403-335-3311 ext 166</b>		

Date: November 24, 2017

Name: Jeff Hahn  
Director of Legislative Services

BYLAW NO. LU 43/17

Being a Bylaw of Mountain View County in the Province of Alberta to amend Land Use Bylaw No. 15/15 affecting SE 32-32-5-5 pursuant to the Municipal Government Act.

---

The Council of Mountain View County, duly assembled, enacts that Bylaw No. 15/15 be amended as follows:

To redesignate from Agricultural District (A) to Aggregate Extraction/Processing District (AEP) an approximate one hundred fifty-nine point seven eight (+/- 159.78) acres (64.66 Hectares) in the South East (SE) Quarter of Section Thirty-two (32), Township Thirty-two (32), Range Five (5), West of the Fifth (5<sup>th</sup>) Meridian, as outlined on Schedule "A" attached hereto.

Received first reading September 13, 2017

Received second reading October 11, 2017

Received third reading October 11, 2017

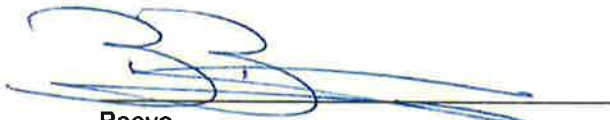
  
Reeve

  
Chief Administrative Officer

October 11 2017  
Date of Signing

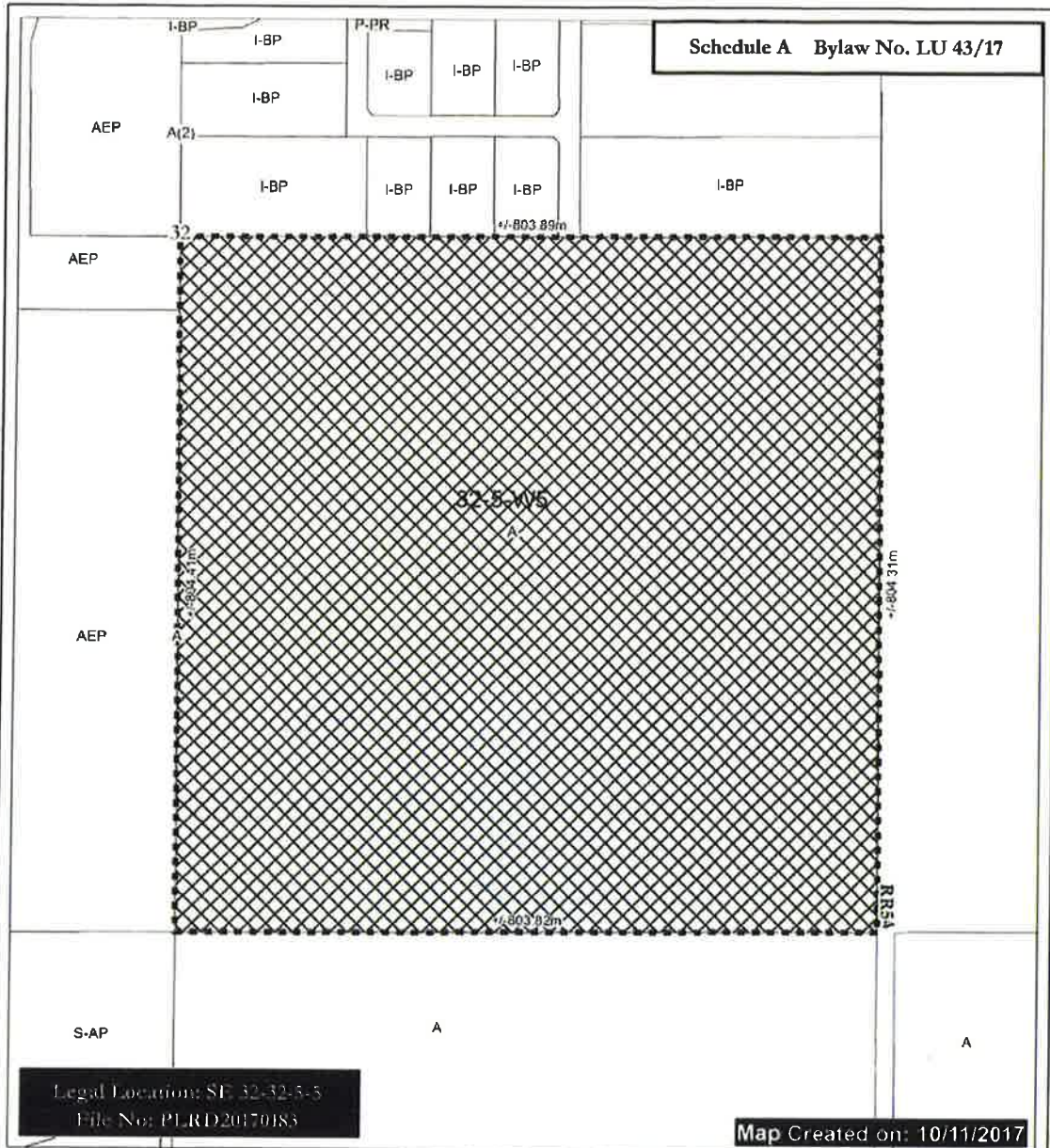

 **From A to AEP**  
(+/- 159.78 ac)

- A = Agricultural District
- A(2) = Agricultural (2) District
- R-CR = Country Residential District
- R-CR1 = Country Residential (1) District
- RE = Residential Farmstead District
- C-LC = Local Commercial District
- I-BP = Business Park District
- I-III = Heavy Industrial District

- P-PC = Parks and Conservation District
- P-PR = Parks and Recreation District
- P-PCR = Parks and Comprehensive Recreational District
- S-IEC = Institutional, Educational and Cultural District
- S-AP = Airport District
- DC = Direct Control
- AEP = Aggregate Extraction / Processing District



0 25 50 100 Meters

Scale: 1:6,000

Mountain View County

SAD 2017 1284 141M AEP Error  
Digitized from 1998, 2010



**Mountain View**  
**COUNTY**